

# Oxford Filtration....

## Duplex Strainers & Filters



### Purpose

Oxford Filtration pipeline strainers and filters protect pumps, nozzles, valves, heat exchangers and other expensive pipeline equipment from harmful contamination by catching dirt and debris.

### Application

**Oxford Filtration duplex strainers and filters provide a simple, cost effective way to separate particle impurities from fluid systems. Duplex strainers are ideal for applications where continuous flow must be maintained, with no flow interruption for basket cleaning.**

Oxford Filtration strainers are listed by Underwriters Laboratories, Inc. (U.L.), and are individually tested to U. L. quality control specifications. These cast pipeline strainers are manufactured according to international standard A.S.T.M. F1199 for use in industrial and marine applications.

Model XD series duplex strainers are furnished in both standard or high pressure models with flanged, screwed, socket weld or butt weld port connections. Internal channels are 100% full-flow, having the same cross-sectional area as the equivalent pipe size. Standard pressure models are furnished with our quick-opening, hand-clamp for easy access. High pressure models are stud-and-nut body cover closures. Refer to our drawings A2334A and A2345 for sizes, ratings and dimensions.

Materials of construction include rugged cast iron, cast steel, stainless steel, bronze or aluminium bodies and covers; cast iron or bronze valve plugs, and brass, carbon steel, stainless steel or monel baskets. Special valve plugs can also be furnished in stainless steel or other materials.

These duplex strainers have a built-in, tapered plug valve that directs flow through either side without shutting off

the flow. A valve handle guard shields the side in use. The standard valve handle swings over the inlet port. Special reverse valve handles that swing over the outlet port can also be furnished. Drain plugs are provided in each of the valve and basket chambers. An adjustable locking flange holds the valve plug on its seat. A separate, external gland is provided to allow easy access to valve stem packing without complete disassembly, even while in service.

Strainer baskets are fabricated from perforated metal. The smallest common perforation size is 1/64 inch in brass and 1/32 inch in stainless steel. Filter baskets are manufactured by using fine mesh wire cloth over supporting perforated metal. Interchangeable strainer, filter and double element baskets provide a flexible range of operating choices. The basket is held on its seat by a spring basket handle. Normal flow is through the interior of the basket which then contains the collected debris when the basket is lifted out for cleaning. Reverse flow is also possible if desired. Magnet inserts are available to help eliminate fine metallic ferrous particles.

All high pressure models with stud-and-nut closure are supplied with balancing valve assemblies to equalize pressure and ease valve turning. These should be specified on standard pressure models when used above the following pressures: 3/4" through 1-1/2" inclusive, 100 psig; 2" & 2-1/2", 80 psig.

An optional lifting jack can be provided to lift the valve plug off its seat for ease of valve turning in rough service.

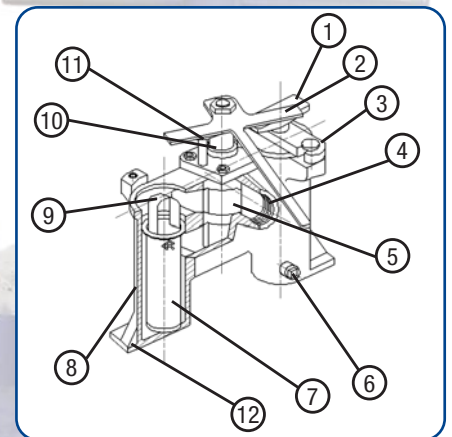

1. Hand clamp requires no special tools on low pressure models.
2. Valve handle shields side in use.
3. Accessible swing yoke closure for easy basket cleaning.
4. Continuous flow without interruption during changeover.
5. Tapered valve plug for durability.
6. Drain connections on each basket chamber.
7. Interchangeable perforated, finer mesh and double area baskets.
8. Bodies individually pressure tested to U.L. specifications.
9. Spring handle holds basket on seat.
10. Independent gland for external stem packing access.
11. Adjustable locking flange establishes valve clearance.
12. Mounting feet provided

# Oxford Filtration Cast Iron Duplex Strainers

## Screwed Connections

**MODEL XD SERIES**  
**HAND CLAMP (YOKE) CLOSURE**  
 for standard pressure to 200psig

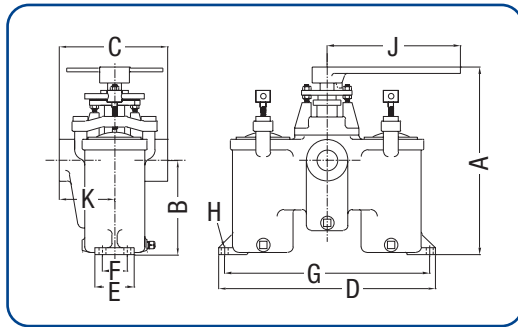

**MODEL XDH SERIES**  
**STUD AND NUT COVER CLOSURE**  
 for high pressure to 400psig

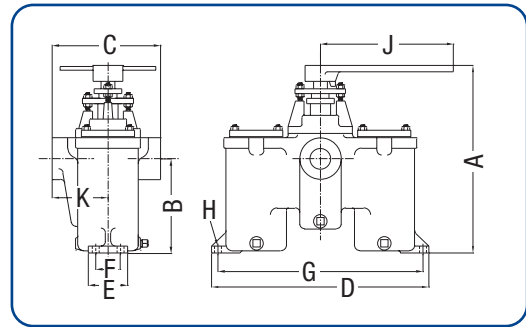

MOD NO	PIPE SIZE BSP	WT KG	A	B	C	D	E	F	G	H	J	K
XD-31D	20	15	257	129	134	277	58	38	257	11	206	70
XD-33D	25	15	257	129	134	277	58	38	257	11	206	70
XD-31	20	19	311	143	172	369	70	45	343	11	308	92
XD-33	25	19	311	143	172	369	70	45	343	11	308	92
XD-35	32	26	337	172	194	388	70	45	362	11	308	99
XD-37	40	26	337	172	194	388	70	45	362	11	308	99
XD-39	50	53	375	200	270	521	76	48	496	15	308	141
XD-41	65	53	375	200	270	521	76	48	496	15	308	141

MOD NO	PIPE SIZE BSP	WT KG	A	B	C	D	E	F	G	H	J	K
XD-31H	20	19	311	143	172	369	70	45	343	11	308	92
XD-33H	25	19	311	143	172	369	70	45	343	11	308	92
-												
-												
XD-35H	32	26	337	172	194	388	70	45	362	11	308	99
XD-37H	40	26	337	172	194	388	70	45	362	11	308	99
XD-39H	50	53	375	200	270	521	76	48	496	15	308	141
XD-41H	65	53	375	200	270	521	76	48	496	15	308	141

## Flanged Connections

**MODEL XDF SERIES**  
**HAND CLAMP (YOKE) CLOSURE**  
 for standard pressure to 200psig

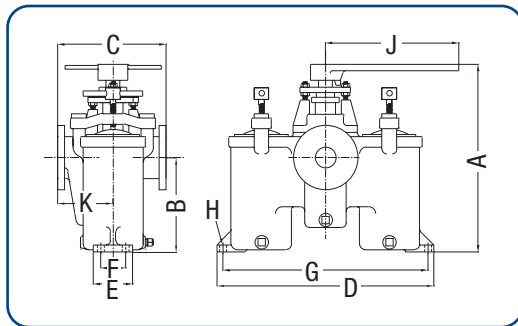

**MODEL XDFH SERIES**  
**STUD AND NUT COVER CLOSURE**  
 for high pressure to 400psig

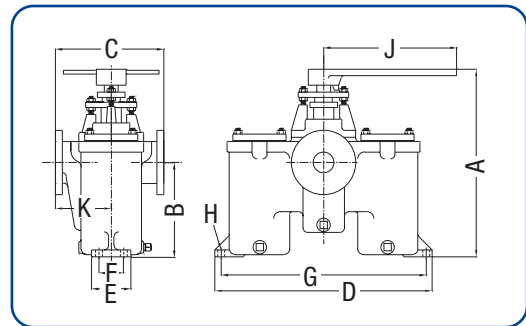

MOD NO	PIPE SIZE FLG	WT KG	A	B	C	D	E	F	G	H	J	K
XD-31F	20	19	311	143	213	368	70	45	343	11	308	118
XD-33F	25	20	311	143	213	368	70	45	343	11	308	118
XD-35F	32	26	337	172	239	388	70	45	362	11	308	121
XD-37F	40	26	337	172	239	388	70	47	362	11	308	121
XD-39F	50	53	375	200	305	521	76	48	496	15	308	158
XD-41F	65	54	375	200	321	521	76	48	496	15	308	158
XD-43F	80	64	448	273	318	527	76	48	496	15	308	175
XD-47F	100	141	526	331	397	642	83	51	610	16	308	227
XD-49F	125	173	664	391	451	705	83	51	673	16	356	251
XD-51F	150	271	724	413	534	934	115	70	902	15	356	305
XD-53F	200	728	948	396	826	1204	273	229	1194	16	356	394

MOD NO	PIPE SIZE FLG	WT KG	A	B	C	D	E	F	G	H	J	K
XD-31FH	20	19	311	143	213	368	70	45	343	11	308	118
XD-33FH	25	20	311	143	213	368	70	45	343	11	308	118
XD-35FH	32	26	337	172	239	388	70	45	362	11	308	121
XD-37FH	40	26	337	172	239	388	70	47	362	11	308	121
XD-39FH	50	53	375	200	305	521	76	48	496	15	308	158
XD-41FH	65	54	375	200	321	521	76	48	496	15	308	158
XD-43FH	80	64	448	273	318	527	76	48	496	15	308	175
XD-47FH	100	141	526	331	397	642	83	51	610	16	308	227
XD-49FH	125	173	664	391	451	705	83	51	673	16	356	251
XD-51FH	150	271	724	413	534	934	115	70	902	15	356	305
XD-53FH	200	728	948	396	826	1204	273	229	1194	16	356	394

# Oxford Filtration Cast Steel Duplex Strainers

## Screwed Connections

**MODEL XDS(S) SERIES**  
**HAND CLAMP (YOKE) CLOSURE**  
 for standard pressure to 200psig

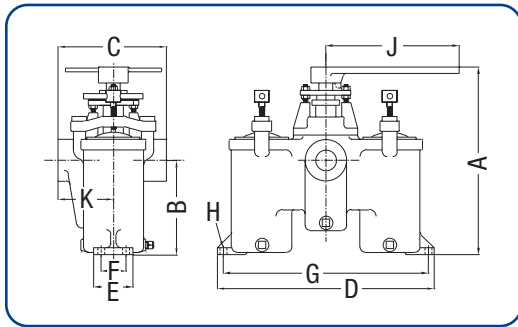

**MODEL XDH SERIES**  
**STUD AND NUT COVER CLOSURE**  
 for high pressure to 400psig

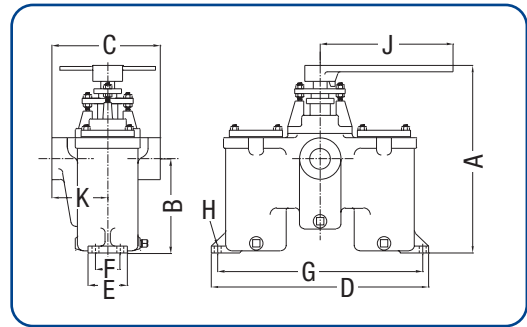

MOD NO	PIPE SIZE BSP	WT KG	A	B	C	D	E	F	G	H	J	K
XD-31DS	20	15	257	138	134	273	58	38	257	11	206	70
XD-33DS	25	15	257	138	134	273	58	38	257	11	206	70
XD-31S	20	19	311	156	172	368	70	45	343	11	308	92
XD-33S	25	19	311	156	172	368	70	45	343	11	308	92
XD-35S	32	26	337	207	194	359	70	45	362	11	308	99
XD-37S	40	26	337	207	194	359	70	45	362	11	308	99
XD-39S	50	53	375	200	270	521	76	48	496	15	308	141
XD-41S	65	53	375	200	270	521	76	48	496	15	308	141

MOD NO	PIPE SIZE BSP	WT KG	A	B	C	D	E	F	G	H	J	K
XD-31HS	20	15	257	138	134	273	58	38	257	11	206	70
XD-33HS	25	15	257	138	134	273	58	38	257	11	206	70
-		19	311	156	172	368	70	45	343	11	308	92
-		19	311	156	172	368	70	45	343	11	308	92
XD-35HS	32	26	337	207	194	359	70	45	362	11	308	99
XD-37HS	40	26	337	207	194	359	70	45	362	11	308	99
XD-39HS	50	53	375	200	270	521	76	48	496	15	308	141
XD-41HS	65	53	375	200	270	521	76	48	496	15	308	141

## Flanged Connections

**MODEL XDFS SERIES**  
**HAND CLAMP (YOKE) CLOSURE**  
 for standard pressure to 200psig

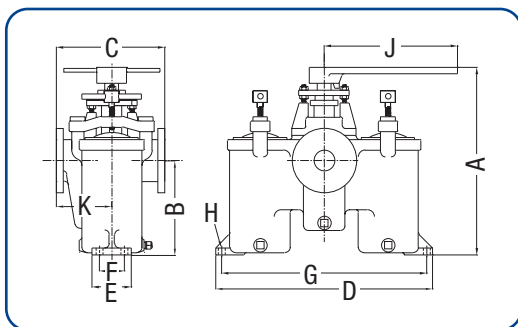

**MODEL XDFSH SERIES**  
**STUD AND NUT COVER CLOSURE**  
 for high pressure to 720psig

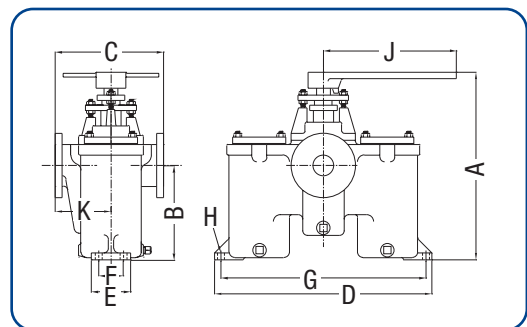

MOD NO	PIPE SIZE FLG	WT KG	A	B	C	D	E	F	G	H	J	K
XD-33FS	25	15	258	131	172	277	58	38	257	11	308	92
XD-35FS	32	28	359	202	210	356	70	38	324	11	308	115
XD-37FS	40	28	359	202	210	356	70	38	324	11	308	115
XD-39FS	50	53	369	191	264	521	76	48	496	15	308	146
XD-41FS	65	55	369	191	264	521	76	48	496	15	308	146
XD-43FS	80	73	451	273	277	521	76	48	496	15	308	159
XD-47FS	100	130	510	324	375	642	83	51	610	16	308	210
XD-49FS	125	178	664	391	451	705	83	51	686	16	356	251
XD-51FS	150	298	683	386	524	877	83	51	839	16	356	296
XD-53FS	200	762	948	396	826	1204	273	229	1169	16	356	394

MOD NO	PIPE SIZE FLG	WT KG	A	B	C	D	E	F	G	H	J	K
XD-33FSH	25	16	258	131	185	277	58	38	257	11	308	99
XD-35FSH	32	30	359	202	215	356	70	38	324	11	308	121
XD-37FSH	40	31	359	202	215	356	70	38	324	11	308	121
XD-39FSH	50	58	369	191	267	521	76	48	496	15	308	153
XD-41FSH	65	60	369	191	270	521	76	48	496	15	308	154
XD-43FSH	80	80	451	273	296	521	76	48	496	15	308	169
XD-47FSH	100	143	510	324	380	642	83	51	610	16	308	218
XD-49FSH	125	195	664	391		705	83	51	686	16	356	
XD-51FSH	150	328	683	386	547	877	83	51	839	16	356	310

# Oxford Filtration Cast Bronze or Aluminium Duplex Strainers

## Screwed Connections

**MODEL XD SERIES - DUPLEX STRAINERS**  
FOR MAXIMUM WORKING PRESSURES TO 200PSIG  
**HAND CLAMP (YOKE) CLOSURE**

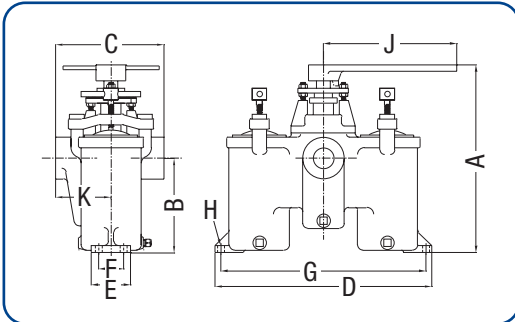

MOD NO	PIPE SIZE BSP	WT KG	A	B	C	D	E	F	G	H	J	K
XD-30	20	14	258	129	134	277	58	38	258	11	207	70
XD-32	25	14	258	129	134	277	58	38	258	11	207	70
XD-36	32	25	359	202	185	356	58	38	324	11	308	99
XD-38	40	25	359	202	185	356	58	38	324	11	308	99
XD-40	50	54	369	191	264	527	76	48	496	15	308	134
XD-42	65	26	369	191	264	527	76	48	496	15	308	134

## Flanged Connections

**MODEL XDF SERIES - DUPLEX STRAINERS**  
FOR MAXIMUM WORKING PRESSURES TO 200PSIG  
**HAND CLAMP (YOKE) CLOSURE**

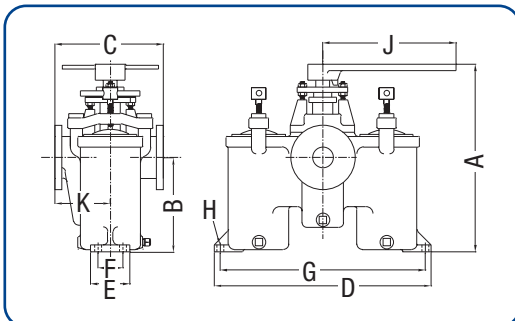

MOD NO	PIPE SIZE FLG	WT KG	A	B	C	D	E	F	G	H	J	K
XD-30F	25	16	258	131	172	277	58	38	257	11	308	92
XD-36F	32	27	359	202	210	356	70	38	324	11	308	115
XD-38F	40	28	359	202	210	356	70	38	324	11	308	115
XD-40F	50	58	369	191	264	521	76	48	496	15	308	146
XD-42F	65	59	369	191	264	521	76	48	496	15	308	146
XD-44F	80	65	451	273	277	521	76	48	496	15	308	159
XD-48F	100	130	510	324	375	642	83	51	610	16	308	210
XD-50F	125	177	664	391	451	705	83	51	686	16	356	251
XD-52F	150	317	683	386	524	877	83	51	839	16	356	296
XD-54F	200	728	948	396	826	1204	273	229	1169	16	356	394



Oxford Filtration manufacture and supply a comprehensive range of strainers including Y Type, Simplex, Temporary and Self Cleaning in addition to the Duplex featured

**OXFORD**  
FILTRATION  
LIMITED

Unit 15,  
Bridgewater Way,  
Windsor, Berks  
SL4 1RD

**Telephone:** +44 (0) 1628 440906

**Fax:** +44 (0) 1628 476667

**Email:** info@oxfordfiltration.com

**Website:** www.oxfordfiltration.com